

How to make REMS portal run in Internet Explorer 11?

Go under 'Tools' or the icon shown below, click on 'Compatibility View settings'.

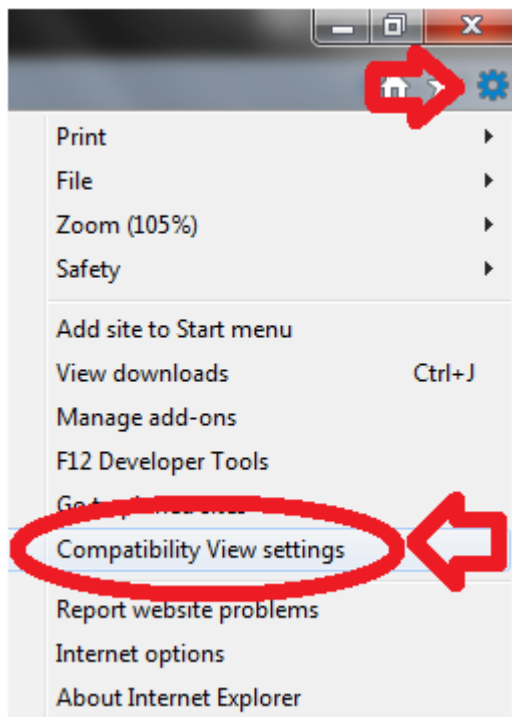

Type in the URL as shown and click on 'Add' button. Finish by closing the dialog box using the 'Close' button at the bottom. **Please take note of the red arrow showing the 2 tick boxes are ticked.**

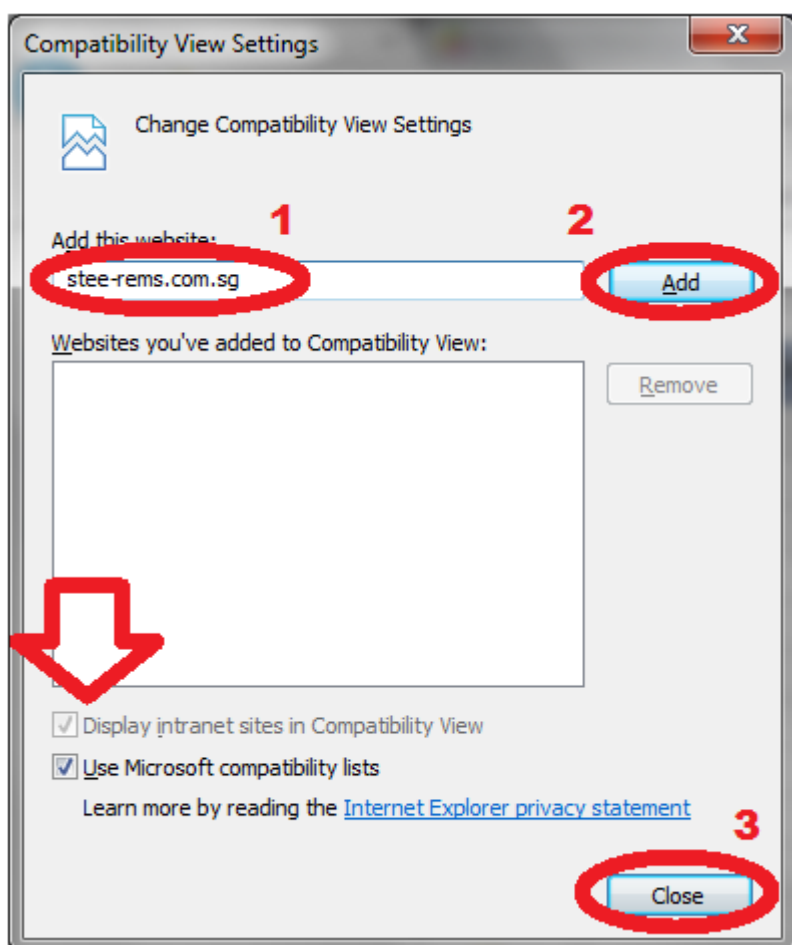

Note: You may need to restart Internet Explorer browser to refresh the settings.